

COMPARISON CHART

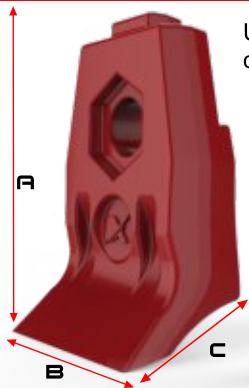

	XFM-DC159-PL	XFM-DC196-PL	XFM-DC220-HF	XFM-DC173-PC	XFM-DC218-PC
DURABILITY IN HIGH IMPACT ROCKY CONDITIONS					
DURABILITY IN HIGH ABRASIVE SANDY CONDITIONS					
DURABILITY IN COLD CLIMATE CONDITIONS					
FASTEST MULCHING PERFORMANCE					
GIVES THE BEST FUEL ECONOMY PERFORMANCE					
PRODUCES FINEST QUALITY OF MULCH					
LEAST AMOUNT OF DAILY MAINTENANCE					
AVERAGE LIFE EXPECTANCY <small>(Life Expectancy Depends on Soil Conditions & Operator Experience)</small>	LOW END HIGH END 90 HRS 120 HRS	LOW END HIGH END 90 HRS PER SIDE 120 HRS	LOW END HIGH END 70 HRS 100 HRS	LOW END HIGH END 250 HRS 500 HRS	LOW END HIGH END 150 HRS 250 HRS





Used in all around conditions such as high impact soils. Ideal for colder climate use. Produces the finest cut of mulch.

aftermarket replacement for:
GYRO-TRAC
fit models - 500HF, 700HF



XFM-DC159-PL

SHARP EDGE PLANER KNIFE REPLACES PART# GT09A10

CUTTER TYPE	STEEL TYPE	STEEL HARDNESS	SINGLE BOLT REQUIRED	WEIGHT
Wood	65Mn	HRC52-55	M20x1.5x80mm	2.45 lbs

A	B	C
LENGTH	WIDTH	LENGTH
4-3/8"	3"	2-1/4"



Used in all around conditions. Added on lasered tungsten carbide / cobalt grit hard surfacing to add protection in abrasive soil conditions. Ideal for colder climate use.

aftermarket replacement for:
GYRO-TRAC
fit models - 500HF, 700HF



XFM-DC220-HF

PLANER KNIFE /W HARFACING PROTECTION REPLACES PART# GT09A10

CUTTER TYPE	STEEL TYPE	STEEL HARDNESS	SINGLE BOLT REQUIRED	WEIGHT
Wood	65Mn	HRC52-55	M20x1.5x80mm	2.60 lbs

A	B	C
LENGTH	WIDTH	LENGTH
4-3/8"	3"	2-1/4"

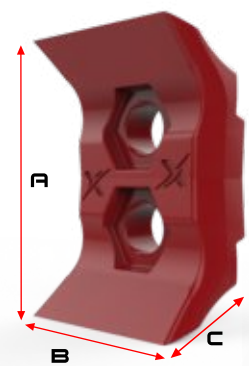

Reversible planer knife. Quick to flip having a 2nd sharp knife ready to go. Used in all around conditions such as high impact soils. Produces the finest cut of mulch.

aftermarket replacement for:
GYRO-TRAC
fit models - 500HF, 700HF



XFM-DC196-PL

REVERSIBLE SHARP EDGE PLANER KNIFE REPLACES PART# GT09A10

CUTTER TYPE	STEEL TYPE	STEEL HARDNESS	SINGLE BOLT REQUIRED	WEIGHT
Wood	42CrMo	HRC40-42	M20x1.5x80mm	2.80 lbs

A	B	C
LENGTH	WIDTH	LENGTH
4-1/4"	2-1/2"	2"

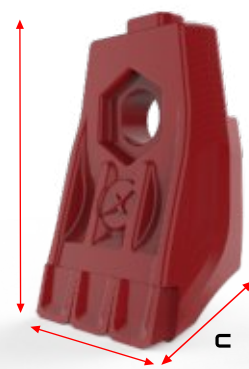

All around conditions. Added sharp edge high quality tungsten carbide tips. Ideal for tougher soil bearing conditions, while giving a finer cut of mulch.

aftermarket replacement for:
GYRO-TRAC
fit models - 500HF, 700HF

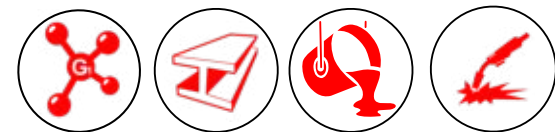

XFM-DC218-PC

SHARP EDGE CARBIDE PLANER KNIFE REPLACES PART# GT09A10

CUTTER TYPE	STEEL TYPE	STEEL HARDNESS	SINGLE BOLT REQUIRED	WEIGHT
Wood	42CrMo	HRC40-42	M20x1.5x80mm	2.80 lbs

A	B	C
LENGTH	WIDTH	LENGTH
4-1/4"	2-1/2"	2"

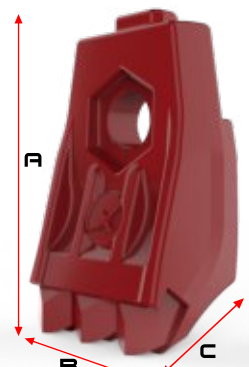

All around conditions. Added pointed edge high quality tungsten carbide tips. Ideal for harshest soil bearing conditions.

aftermarket replacement for:
GYRO-TRAC
fit models - 500HF, 700HF



XFM-DC173-PC

POINTED TIP CARBIDE PLANER TEETH REPLACES PART# GT09A10

CUTTER TYPE	STEEL TYPE	STEEL HARDNESS	SINGLE BOLT REQUIRED	WEIGHT
Wood	42CrMo	HRC40-42	M20x1.5x80mm	2.80 lbs

A	B	C
LENGTH	WIDTH	LENGTH
4-1/4"	2-1/2"	2"

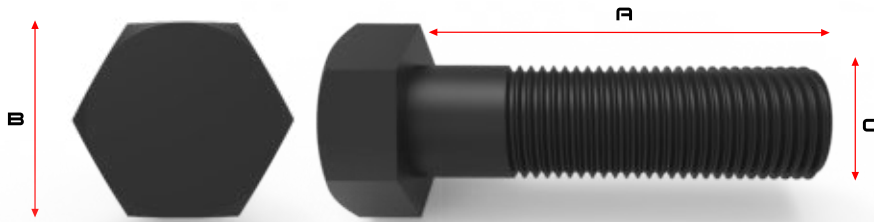

HEX BOLT

PART NUMBER	THREAD SIZE	MATERIAL TYPE	GRADE	HEAD TYPE	DRIVE SIZE	A LENGTH	B DIA	C DIA	FIT TEETH
M20x1.5x80 HEX	M20x1.5	Black Oxide Alloy Steel	12.9	Hex	30mm	80mm	30mm	20mm	XFM-DC159-PL, XFM-DC173-PC, XFM-DC196-PL, XFM-DC220-HF, XFM-DC218-PC

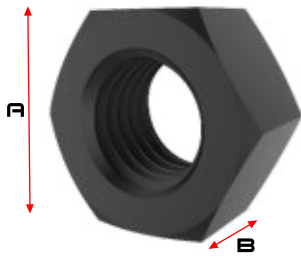

NUT

PART NUMBER	THREAD SIZE	MATERIAL TYPE	GRADE	HEAD TYPE	WRENCH SIZE	A WIDTH	B THICKNESS	FIT TEETH
M20x1.5	M20x1.5	Black Oxide Alloy Steel	12.9	Hex	30mm	30mm	25mm	XFM-DC159-PL, XFM-DC173-PC, XFM-DC196-PL, XFM-DC220-HF, XFM-DC218-PC

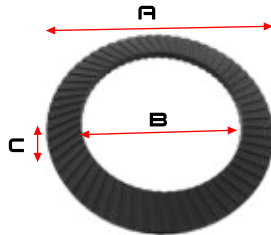

SERRATED WASHER

PART NUMBER	MATERIAL TYPE	MATERIAL HARDNESS	SERRATED	A OD	B ID	C THICKNESS	FIT BOLTS SIZE
M20W	Black Oxide Alloy Steel	C40	TOP & BOTTOM	29.85mm	20.85mm	1.86mm	M20

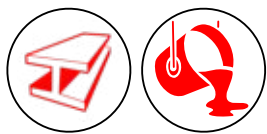
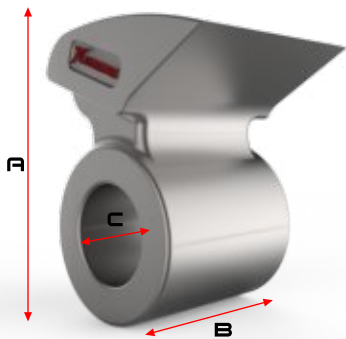

XFM-FA132
SWING HAMMER

aftermarket replacement for:
GYRO-TRAC
fit models - GT25 Toma-Ax

CUTTER TYPE	STEEL TYPE	STEEL HARDNESS	SHAFT REQUIRED	WEIGHT	A	B	C
Wood	40CrMo	HRC40-42	1-1/4" Dia	4.00 lbs	3-5/8"	2-3/8"	1-1/4"

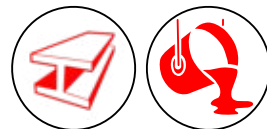
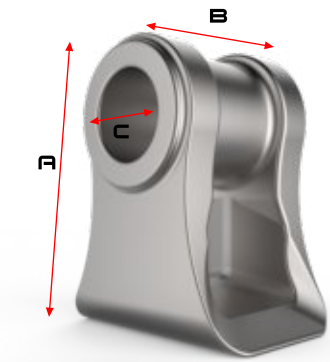

XFM-GT273
REVERSIBLE SWING HAMMER

aftermarket replacement for:
GYRO-TRAC
fit models - GT25 Toma-Ax

CUTTER TYPE	STEEL TYPE	STEEL HARDNESS	SHAFT REQUIRED	WEIGHT	A	B	C
Wood	40CrMo	HRC40-42	1-1/4" Dia	3.52lbs	4-1/8"	3-3/4"	1-1/4"