

aftermarket replacement for:
NOKAMIC
fits - NSS-2700 & NSS-2900

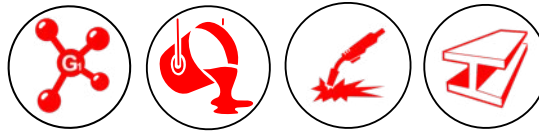
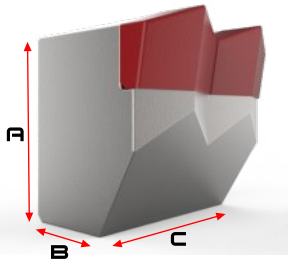

XFM-NO276
DUAL CARBIDE TEETH

CUTTER TYPE	STEEL TYPE	STEEL HARDNESS	THREAD TYPE	WEIGHT	A LENGTH	B LENGTH	C WIDTH
Wood	42CrMo	HRC38-42	3/4-16	1.70 lbs	1-7/8"	1"	2-1/8"

aftermarket replacement for:
NOKAMIC
fits - NSS-2700 & NSS-2900

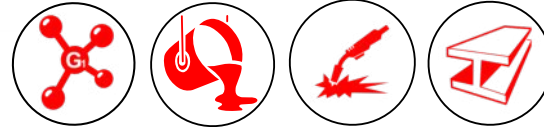
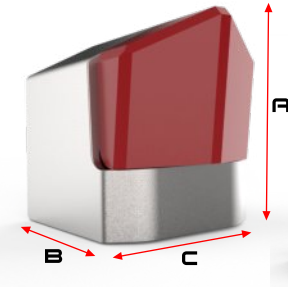

XFM-NO278
SINGLE CARBIDE TEETH

CUTTER TYPE	STEEL TYPE	STEEL HARDNESS	THREAD TYPE	WEIGHT	A LENGTH	B LENGTH	C WIDTH
Wood	42CrMo	HRC38-42	3/4-16	1.35 lbs	1-3/4"	1-1/2"	1-5/8"

aftermarket replacement for:
NOKAMIC
fits - NSS-2700 & NSS-2900

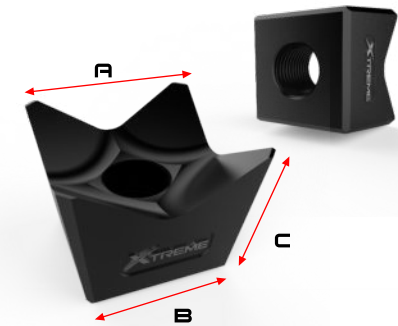

XFB-QU103
REVERSIBLE STEEL BEAVER TEETH

CUTTER TYPE	STEEL TYPE	STEEL HARDNESS	THREAD TYPE	WEIGHT	A LENGTH	B WIDTH	C HEIGHT
Wood	65Mn	HRC 58-62	3/4" -16	0.81 lbs	2"	1-11/16"	1-9/16"

aftermarket replacement for:
NOKAMIC
fits - NSS-2700 & NSS-2900

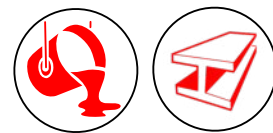
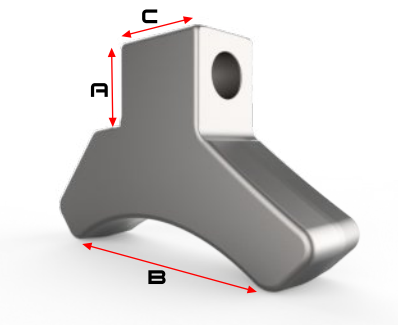

XFM-NO300-H
TOOL HOLDER

CUTTER TYPE	STEEL TYPE	STEEL HARDNESS	BOLT OPENING	WEIGHT	A LENGTH	B LENGTH	C WIDTH
Wood	42CrMo	HRC33-37	3/4	5.25 lbs	1-1/2"	4-1/2"	2"

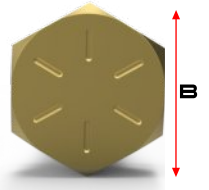
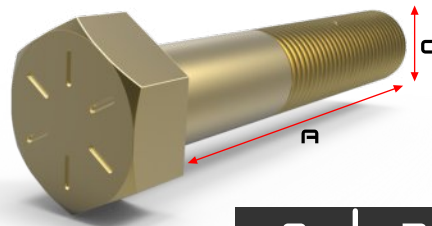

HEX BOLTS

PART NUMBER	THREAD SIZE	MATERIAL TYPE	GRADE	HEAD TYPE	DRIVE SIZE	A	B	C	FIT
						LENGTH	LENGTH	DIA	
3/4-16 x 3" HEX	3/4-16"	Plated Steel	8	HEX	3/4"	3"	1-1/8"	3/4"	XFM-LO276, XFM-LO278, XFM-LO300-H, XFB-QU103

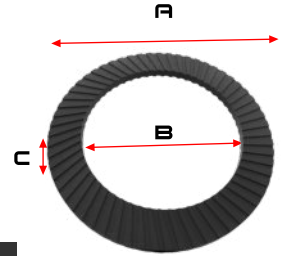

BEVELLED WASHER

PART NUMBER	MATERIAL TYPE	MATERIAL HARDNESS	SERRATED	A	B	C	FITS BOLTS
				OD	ID	THICKNESS	
M20W	Black Oxide Alloy Steel	C40	TOP & BOTTOM	29.85mm	20.85mm	1.86mm	M20 & 3/4"